

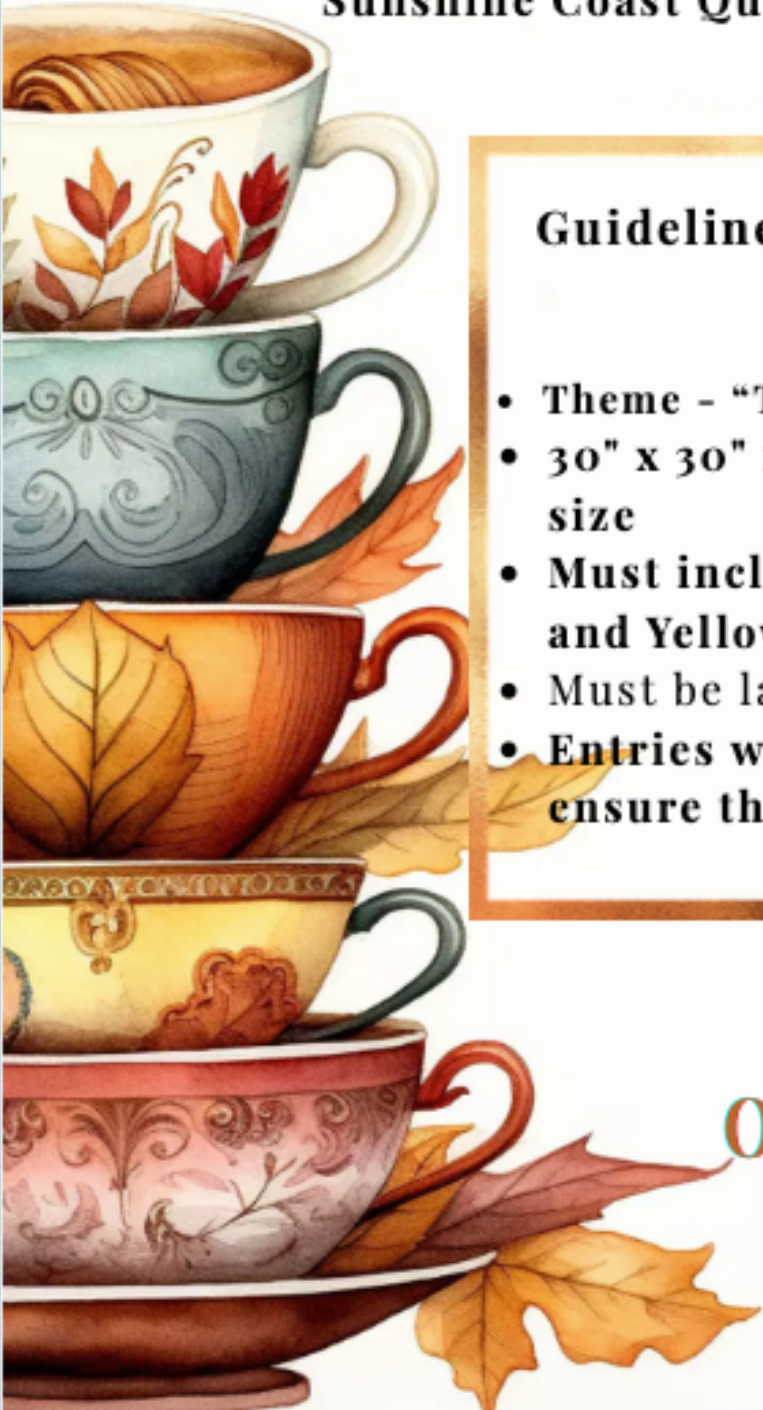

# Hands Across the Water

Sunshine Coast Quilters Guild



## Guidelines for Challenge Quilt

- Theme - "Tea"
- 30" x 30" maximum finished size
- Must include colours Brown and Yellow
- Must be labelled on back
- Entries will be checked to ensure this criteria is met

SEE YOU  
OCTOBER 3<sup>RD</sup>,  
2026

# Vintage Teapot Quilt

\*Feel free to create your teapot block in any colours you wish. We just ask that it have a white (ish) background and that you bring 2 blocks – 1 for a draw amongst attendees and 1 to be made into a quilt for a community project. Also, please don't trim the block.

\*\* Please note this quilt block is from a free pattern entitled Apple Butter Teapot Quilt from Tilda's World. Here is the link if you'd like more details: <https://threadloop.app/patterns/teapot-quilt-by-tilda-s-world>

**Figure A** Layout & Cutting for Teapot Block

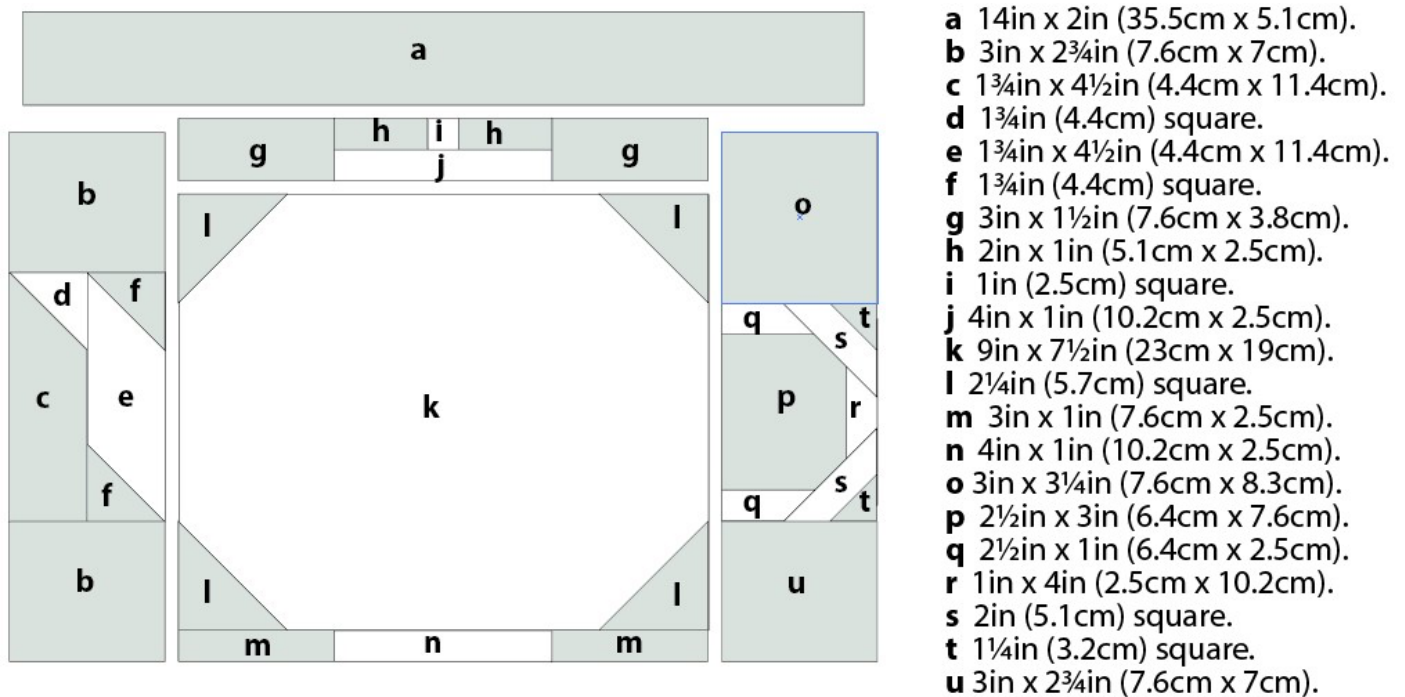

**Fig A** shows the layout of the block, with the letters indicating the cut sizes of the fabric pieces. When you have cut all the pieces for one block, lay them out in the different sections of the block as best you can.

**Figure B** Sewing the Teapot Body

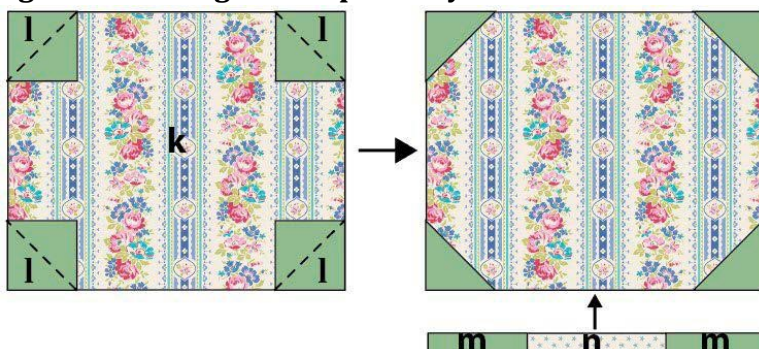

Take piece **k** and four **l** squares and create triangle corners on the larger piece. For the base of the body, sew two **m** pieces to the sides of an **n** piece. Press and then sew this to the bottom of the body.

### Figure C Sewing the Spout

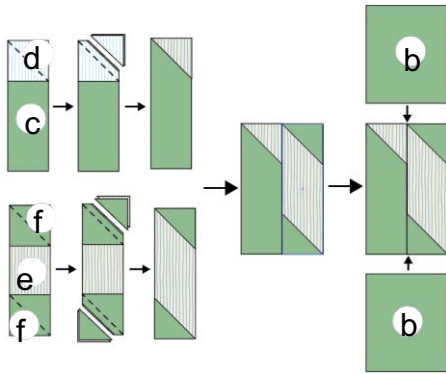

For the spout, use pieces **b**, **c**, **d**, **e** and **f**. Now sew units **b/c** together with unit **d/e/e**. Take this pieced unit and add the two rectangle pieces **a** to the top and bottom, and press. Set aside for the moment.

Create a triangle on a corner as follows. On the wrong side of a **c** square mark a diagonal line. Place the square right sides together with piece **b**, matching the top edges. Sew along the marked diagonal. Trim excess fabric  $\frac{1}{4}$ in (6mm) away from the sewn line and press the corner outwards. Repeat this process with piece **d** and two **e** squares. Now sew units **b/c** together with unit **d/e/e**. Take this pieced unit and add the two rectangle pieces **a** to the top and bottom, and press. Set aside for the moment.

### Figure D Sewing the Handle

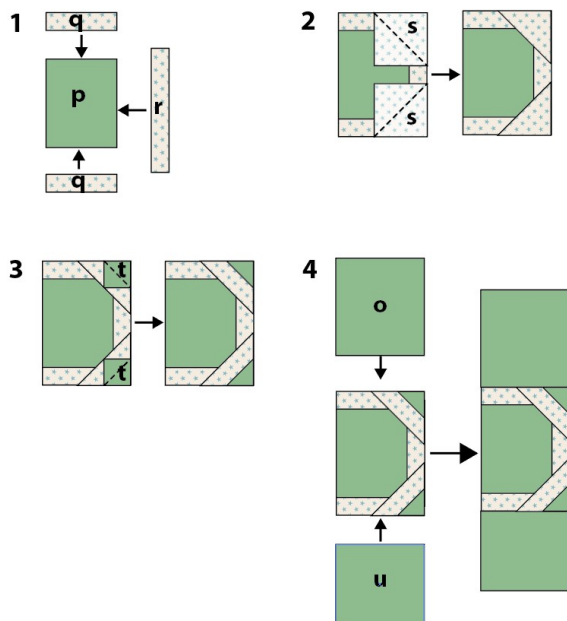

For the handle, use pieces **o**, **p**, **q**, **r**, **s**, **t** and **u**.

Start by sewing the two **q** pieces to the top and bottom of the **p** piece. Press and then add piece **r** to the right-hand side of the unit. The corners **s** and then **t** are created using the same technique described in Figure C. Finally, add piece **o** to the top of the handle and piece **u** to the bottom and press.

**Figure E Sewing the teapot lid**

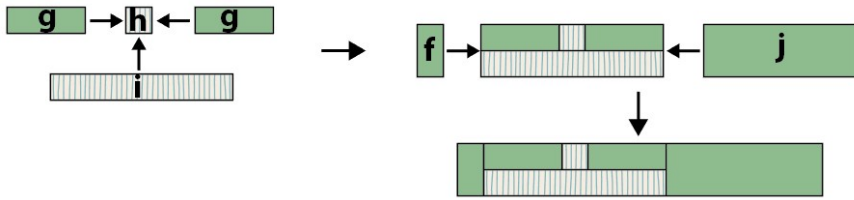

For the lid, use pieces **g**, **h**, **i** and **j**. Sew pieces **g**, **h** and **g** together in a row and press. Add piece **i** to the bottom of the unit. Now sew piece **f** to the left-hand side of the unit and piece **j** to the righthand side, and press. Set the unit aside for the moment.

**Figure F Assembling Teapot Block**

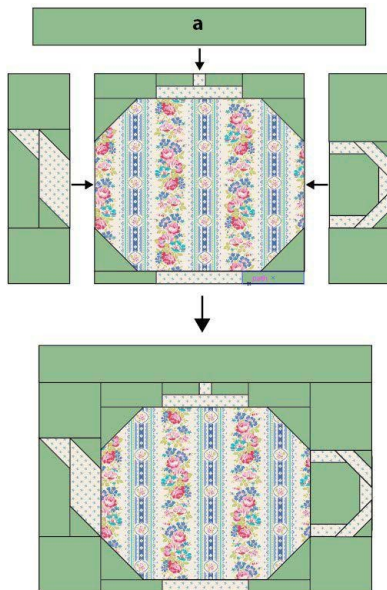

To assemble the block follow **Fig F**. Sew the spout section and the handle section to the body section and press. Add the long strip of piece **a** to the top of the block. The block should be 14in x 10½in (35.5cm x 26.7cm) at this stage

